

Cactus Trio DIY Embroidery Tote Bag Pattern



Cactus Tote Bag

This simple, boxy tote bag is embellished with a fun trio of hand embroidered, potted cactus.

Instructions for both the bag and the embroidery are included.

Choose from two size bags:

Medium - (pictured above)

~14" tall x 11.5" wide x 4" deep

Large - (pictured to the left)

~15" tall x 12" wide x 6" deep

Materials List

- Exterior Fabric for bag, pocket, & strap:

Choose a medium weight fabric that you can press with a hot iron and is suitable for hand embroidery. The fabric pictured above is a lightweight denim cotton blend.

Medium Bag:

2 15" x 18" rectangles for exterior

1 12" x 12" square for pocket

2 4" x 28" strip for handle

Large Bag:

2 17" x 20" rectangles for exterior

1 12" x 12" square for pocket

2 4" x 28" strip for handle

- Liner Fabric for bag & pocket:

Choose a lightweight fabric in a contrasting color.

Medium Bag:

2 15" x 18" rectangles for liner

1 9" x 10.5" rectangle for pocket liner

Large Bag:

2 17" x 20" rectangles for liner

1 10.5" x 11" rectangle for pocket liner

- Medium weight iron-on interfacing

Medium Bag:

2 15" x 18" rectangles

Large Bag:

2 17" x 20" rectangles

Embroidery Materials

- 10" Embroidery Hoop
- Embroidery Needle, size 7 or 9
- Water Soluble Pen or other items for pattern transfer. (See the pattern transfer instructions below)
- Small Scissors
- DMC Embroidery Floss:
922, 3346, 734, 612, 469, 3854

The floss colors are for guidance only. Feel free to substitute or change the colors.

Embroidery Pattern Transfer Instructions

Light Table/ Window:

Place the pattern on a light table or tape it to a bright window. Position the fabric on top and secure in place. Trace the pattern onto the fabric using a water erasable transfer pen. The markings from this pen will remain until washed gently with water.

*Pro tip: A computer or tablet screen makes a great light box! Simply open this PDF on your computer, tape the fabric over the pattern on the screen, and trace it using the provided pen. No printer needed!

Iron On Transfer Pencil or Pen:

This method uses an iron on transfer pen or pencil which can be found at most fabric/ sewing stores. First, print the REVERSE IMAGE pattern. Trace the pattern with the iron on pencil or pen. Place the traced pattern on an iron-safe surface and secure the fabric on top. Press a hot iron on the fabric for 5-10 seconds. Do not move the iron around. Gently lift an edge of the fabric to check that the design has transferred before removing the fabric.

*This method will leave permanent marks that need to be covered with embroidery or they will show on the finished piece.

Dressmaker's Transfer Paper:

Transfer Paper can be found at many fabric or craft stores. It is coated on one side with a powdery ink that will wash out of the fabric. Transfer paper comes in both light and dark colors.

To use, secure your fabric to a flat, hard surface, cover with a piece of transfer paper (powder side down) and place the printed pattern on top. Trace the pattern using a pencil, fine tipped pen, or stylus. Press very firmly and make sure the paper does not move.

This is the best method for transferring patterns to a dark fabric. A white or yellow transfer paper will show up nicely on dark fabric.

*Pro Tip: The transfer lines from this paper fades fast. After 24 hours you will only see faint lines. For best results, transfer a small portion of the pattern, stitch, then repeat the transfer process for a different part of the pattern until finished.

Full Size Embroidery Design

Fits medium & Large Bags

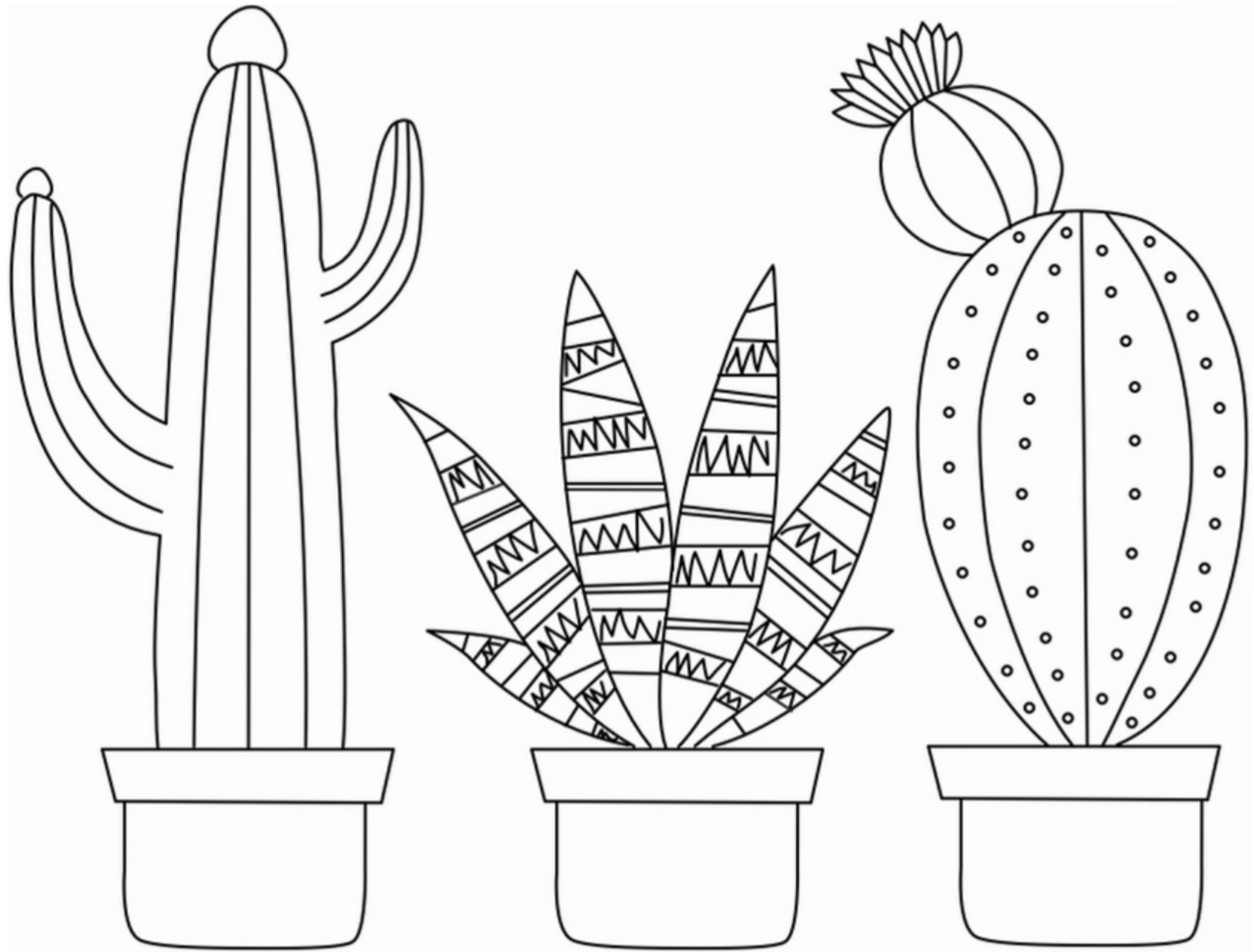

Reverse Pattern For Iron-On Transfer

Fits medium & Large Bags

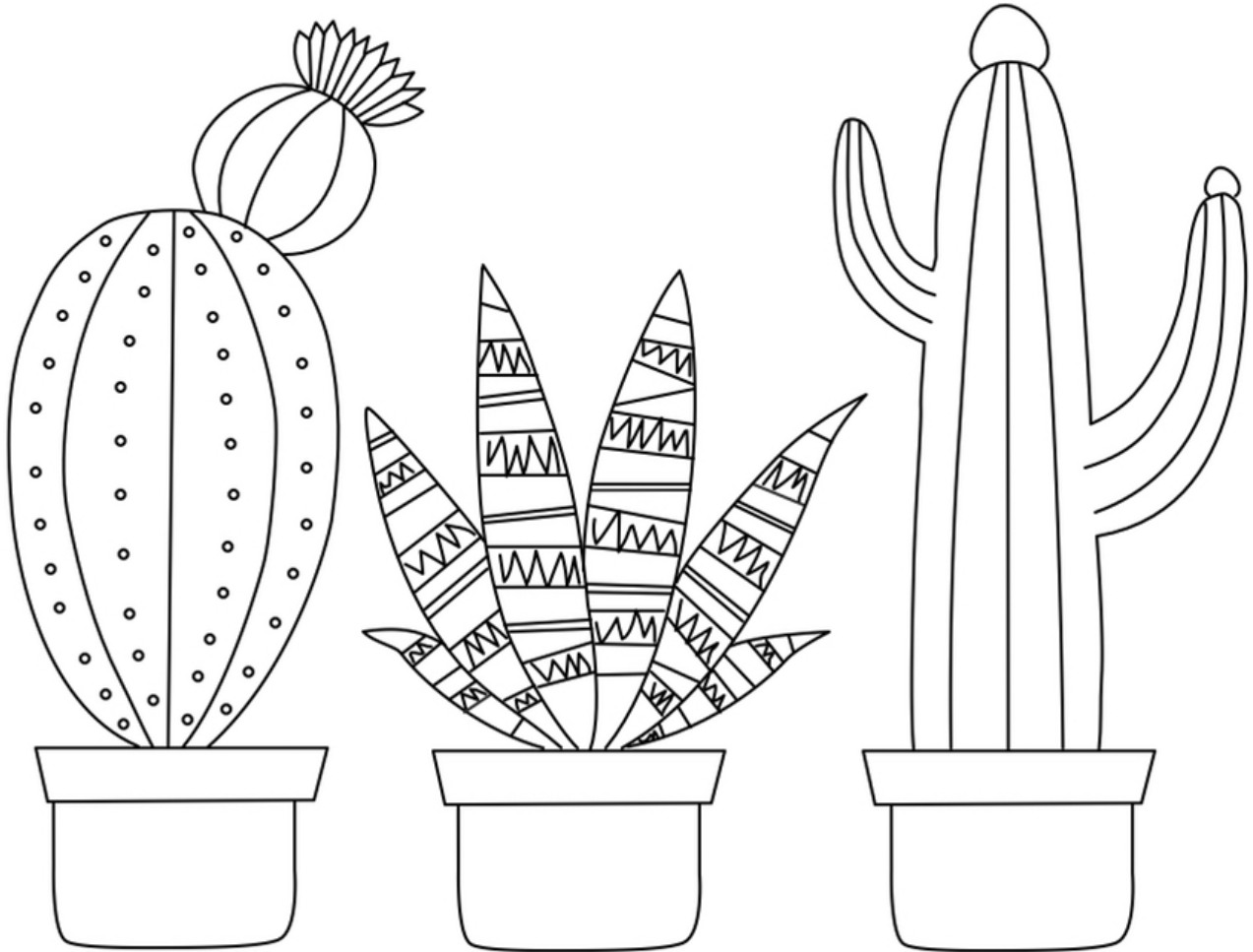

Color & Stitch Guide

Need help with embroidery stitches?

Visit: WanderingThreadsEmbroidery.com/embroidery-stitch-tutorials

Cactus #1:

Color - DMC 3346

Stitch - (Outline) Split, 4 strands
(Inner Ribs) Running, 2 strands

Flower:

Color - DMC 3854

Stitch - Back, 2 strands

Flowers:

Color - DMC 922

Stitch - French
Knot, 3 strands

Cactus #2:

Color - DMC 734

Stitch - (outline)Back,
(middle)Split & Satin,
2 strands

Cactus #3:

Color - DMC 469

Stitch - Stem, 4 strands

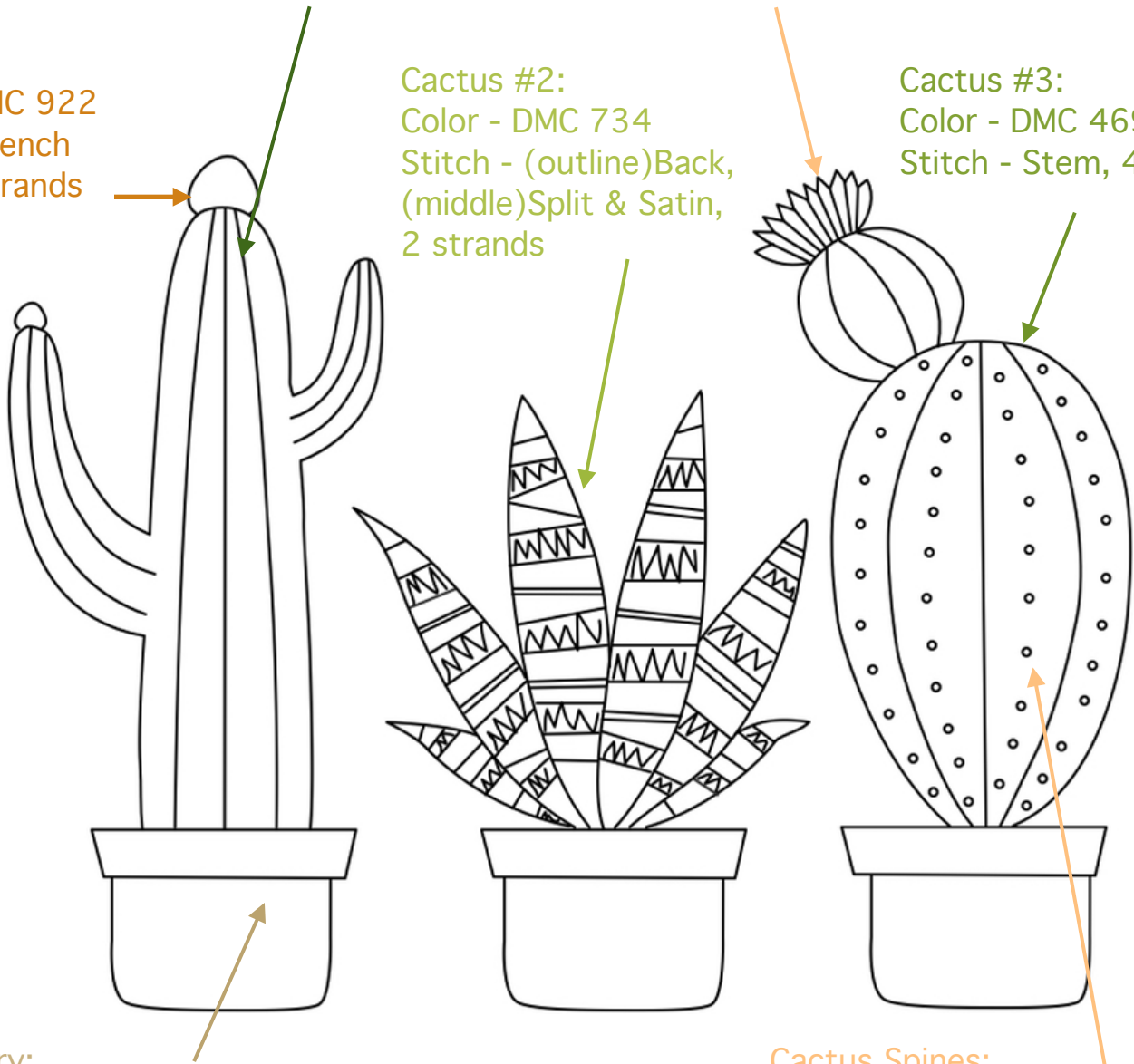

Pottery:

Color - DMC 612

Stitch - Split, 2 strands

Cactus Spines:

Color - DMC 3854

Stitch - French Knot, 2 strands

Tote Bag Sewing Instructions

- Following the guide above, stitch the embroidery pocket. Remove from the hoop and gently wash away any markings. Lay flat on a towel and let air dry. Cover with a light cloth and iron gently to remove wrinkles.
- Trim the pocket into a rectangle that is taller on the sides than the top & bottom.
Medium Bag: Trim pocket to 9" x 10.5"
Large Bag: Trim pocket to 10" x 11.5"
- Line up and pin the pocket liner fabric to the inside of the embroidered pocket. Using a 1/4" seam allowance, sew a 1/2" hem on top. Press a 1/4" seam under on the other three sides. Set aside. (pic 1)
- Following the instructions on your interfacing, fuse it to the wrong sides of the two exterior fabric rectangles.
- Measure, mark, and cut squares from the bottom corner of each piece.
Medium Bag: Cut out 2.5" squares
Large Bag: Cut out 3" squares (pic 2)
- Position and pin the pocket to the right side of one of the exterior rectangles.
Medium Bag: Position 4.5" from top & 3.25" from each side
Large Bag: Position 5" from top & 3.5" from each side. (pic 3)
- Edge stitch the pocket onto the front side of the bag. This seam will be visible so be sure to use a coordinating color thread.
- Line up the two exterior rectangles with the right sides together. Pin the fabric together, and using a 1/4" seam allowance, sew down the long sides and across the bottom. (pic 4)

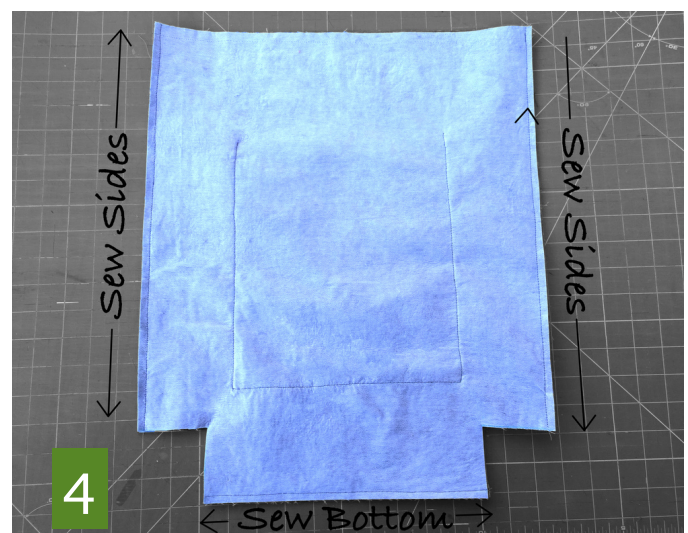
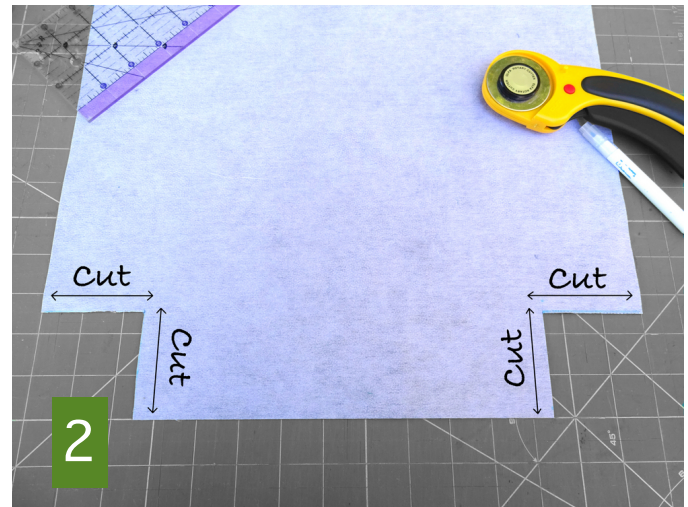
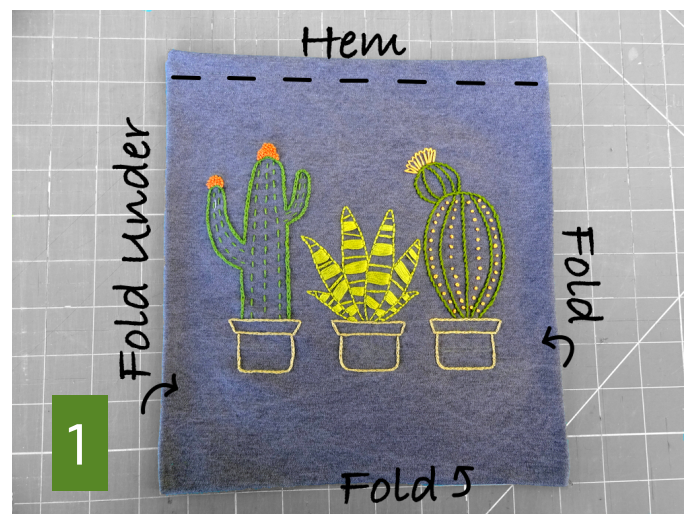

Tote Bag Sewing Instructions (cont.)

- Join the sides of the fabric together where you cut out the squares. Match up the seams and pin together. (pic 5)
- Using a 1/4" seam allowance, stitch across to create the boxy bottom and sides of the bag. (pic 6)
- Lay out the lining fabric rectangles on a flat surface. Measure, mark, & cut squares from the bottoms of each corner. Use the same measurements as you did for the outer fabric.
- Pin the wrong sides of the liner fabric together and using a 1/4" seam allowance, sew down the long sides and across the bottom.
- Finish the corners the same as before.
- Turn the liner right side out and position it over the still inside-out exterior bag; You will now have a bag with the liner on the outside. (pic 7)
- Construct the handles. Fold one of the 28" x 4" fabric strips in half lengthwise. Press with a hot iron.
- Unfold and press flat with your fingers. Fold the two edges into the center so they meet on the first fold line. Fold in half one more time and press with a hot iron. (pic 8)
- Edge stitch down the long side of handle. You can sew both sides for symmetry, or just the side with the open seam. This seam will be visible so be sure to use a coordinating thread color.

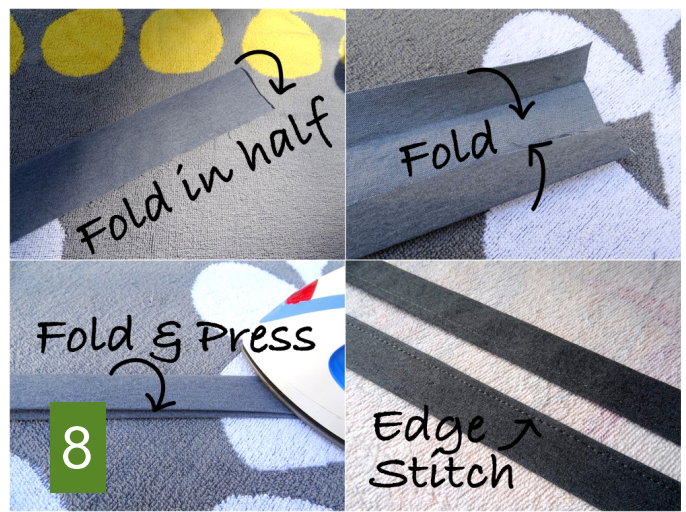
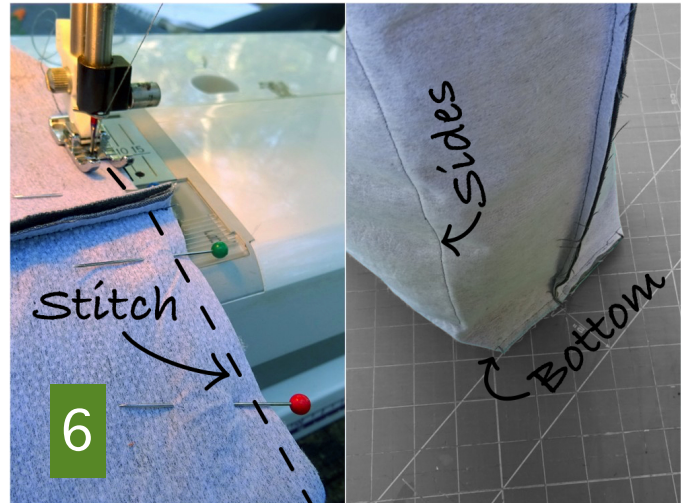
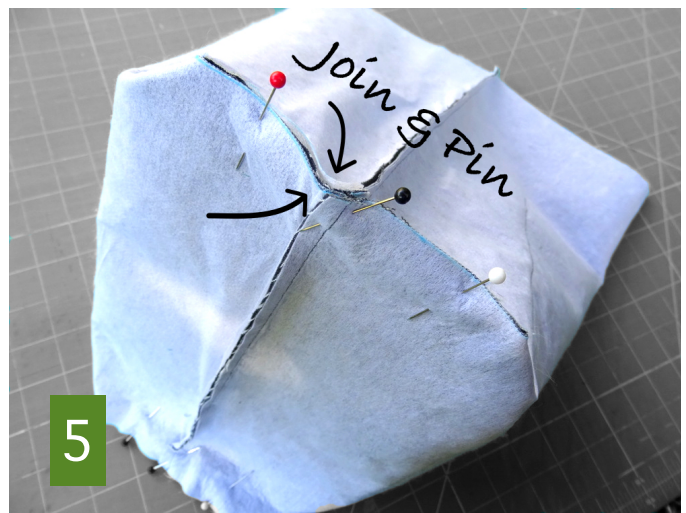

Tote Bag Sewing Instructions (cont.)

- With the bag still inside out, fold and press under a top seam measuring $\frac{3}{4}$ ". Position the handles under the fold. Make sure they are not twisted.
Medium Bag: Position the outside edge of the handles 3.25" from the sides
Large Bag: Position the outside edge of the handles 4.5" from the sides (pic 9)
- Fold and press another $\frac{3}{4}$ " seam on the top of the bag. The fabric will fold over the handles. Pin the seam in place. (pic 10)
- Edge stitch around the top of the bag on the bottom edge of the seam. Flip the handles up and secure them by edge stitching boxes where the handles meet the the top seam. (pic 11)
- Turn the bag right side out and you are done!

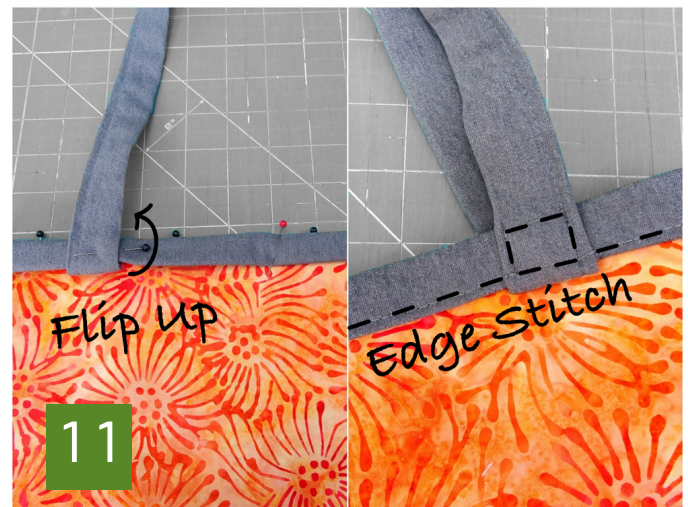
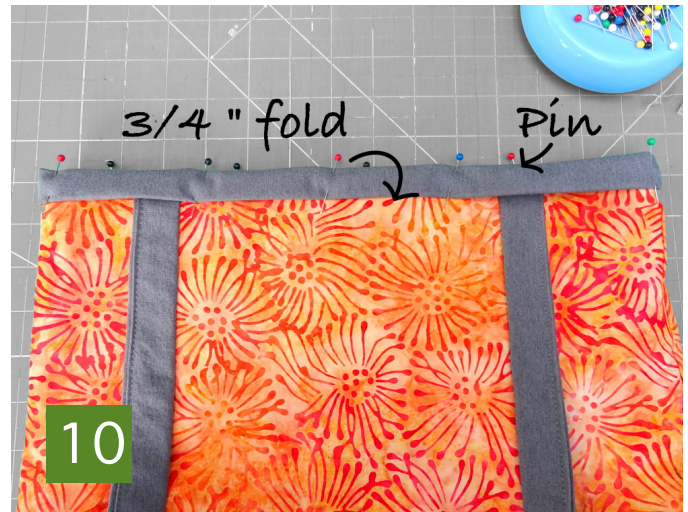

Love your Cactus Tote Bag? The Flower Tote Bag offers the same great style and simple design with a lovely embroidery pattern featuring five unique flowers.

Visit: www.wanderingthreadsembroidery.com/product/wildflower-embroidery-tote-bag-pattern